

# ADMIRAL PARKING LOT INFORMATION

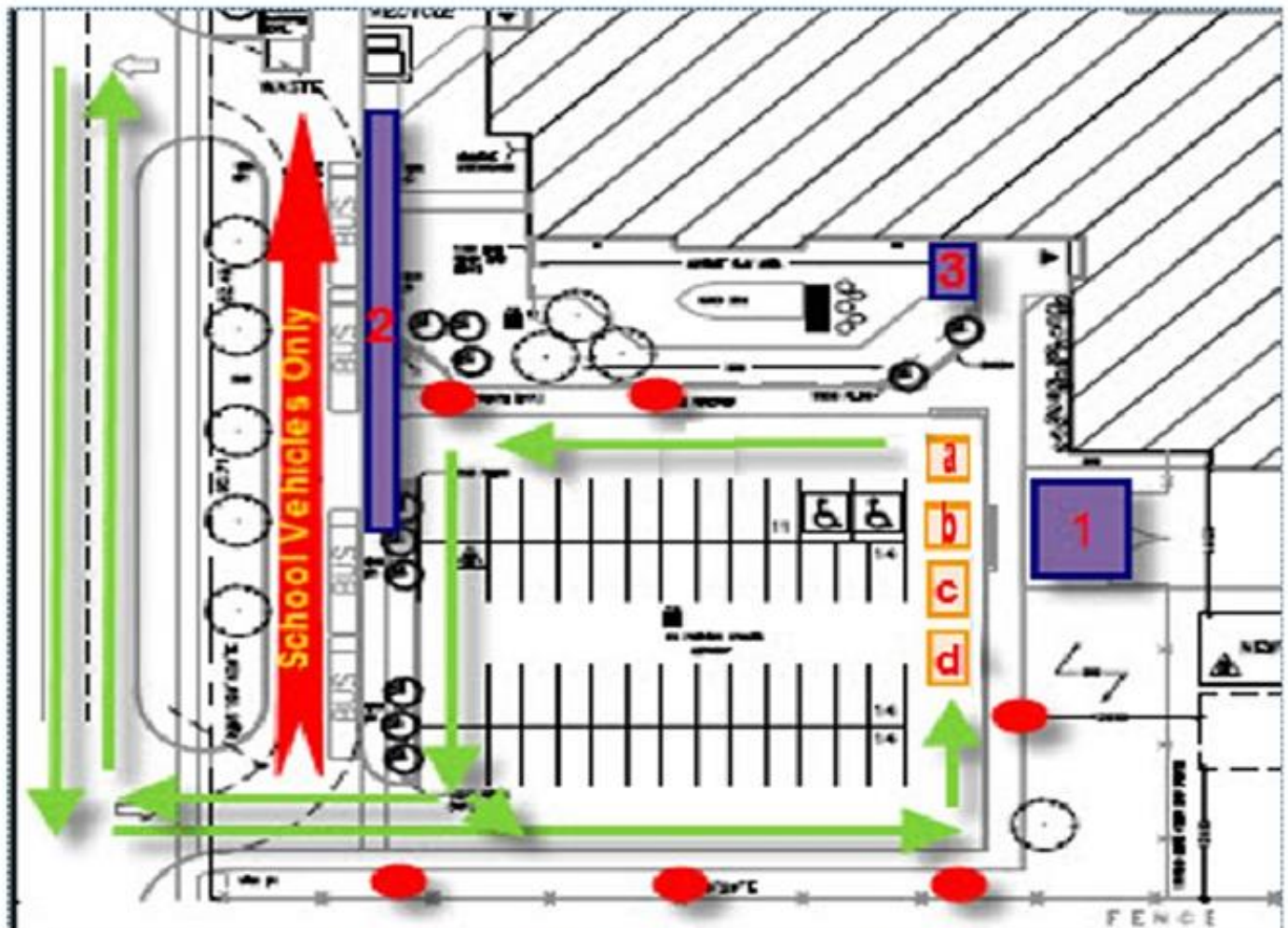

## Kiss'n'Ride Instructions

- Parents who are loading and unloading children are asked to follow the directional arrows.
- Students should only be loaded or unloaded in the loading zones, marked "a,b,c and d".
- Students who are waiting for pick-up in vehicles should be waiting in the zone marked "1".
- Kindergarten students who are being picked up by walking parents will wait in Zone 3 (the kindergarten yard).
- The wide arrow zone marked "School Vehicles Only" must not be used by parents at any time.
- Zone 2 is to be used by students who are loading onto or unloading from the bus.
- The solid ovals indicate a NO PARKING zone. Cars should not be abandoned (a driver must be in the vehicle at all times) in this zone. No children should be exiting or entering vehicles in this area. This is a FIRE ROUTE. Cars in this lane are in queue for the loading/unloading zones only and must be able to exit immediately, in the case of an emergency.
- In the loading/unloading zone, children should be using the passenger side ONLY.
- Upon pickup, if students are not present and ready in Zone 1, parents need to continue circling around the lot.
- Parents who need to enter the school must park in the designated parking areas. Students are not permitted to cross the road or parking lot to reach a car unless escorted by an adult.

Students are encouraged to walk to and from school as much as possible.

For Walkers....

- Students enter and exit the school property by the north entrance.
- Primary students exit the school at 3:15 pm dismissal bell via the green hall doors on the north side of the school.
- Portable students are to use the walkway at the north side of the school when leaving school grounds.
- Students are NOT to exit through the front doors of the school unless accompanied by an adult.